



南通博朗冷冻设备有限公司(工厂)
Nantong BOLANG Refrigeration Equipment Co.,Ltd (Factory)
南通博朗节能科技有限公司(国际贸易子公司)
Nantong BOLANG Energy Saving Technology Co.,Ltd (International Trade Subsidiary)

制冰机 ICE MAKING MACHINE

CONDENSING DEDICATION IN ICE
MAKING TECHNOLOGY TO CREATE EXCELLENCE

凝心聚力 技术创造卓越



一站式冷链物流解决方案制造商
MANUFACTURER OF ONE-STOP
COLD CHAIN LOGISTICS SOLUTIONS

工厂地址: 南通市高新区碧华路1199号东久(南通)智造园A6
电话: +86 18862802935
电子邮件: market@ntboltech.com
网站: www.ntboltech.com

Factory Address: A6, Dongjiu (Nantong) Smart Park, No. 1199, Bihua
Road, Nantong Hi-Tech Zone, Nantong, China
Tel (WA): +86 18862802935
E-mail: market@ntboltech.com
Website: www.ntboltech.com



WeChat



WhatsApp

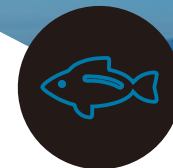

FOOD
食品



INDUSTRY
工业



CHEMICAL
化学



MEDICINE
医药

公司简介



业务范围

BUSINESS SCOPE

冷冻储存和冷藏
FROZEN STORAGE AND REFRIGERATION

商业和超市冷链
COMMERCIAL AND SUPERMARKET COLD CHAIN

食品加工
FOOD PROCESSING

海鲜冷冻
SEAFOOD FREEZING

低温实验
LOW TEMPERATURE EXPERIMENT

工业制冷
INDUSTRIAL REFRIGERATION

生物医学制冷
BIOMEDICAL REFRIGERATION

冷链物流
COLD CHAIN LOGISTICS

畜禽屠宰和加工
LIVESTOCK AND POULTRY SLAUGHTER AND PROCESSING

中央厨房
CENTRAL KITCHEN



专业服务团队
PROFESSIONAL SERVICE TEAM



不同规格型号
VARIOUS SPECIFICATIONS



专业技术人员
PROFESSIONAL TECHNICAL STAFF

南通博朗冷冻设备有限公司成立于2012年，是一家集设计、研发、生产、销售、服务于一体的综合性公司，专业生产各种类型制冰机冷冻冷藏设备；食品速冻加工设备及热回收设备；化工冷水机组、尾气回收装置设备，以及一站式冷链物流的解决方案。

博朗主营：块冰机、管冰机、方冰机、片冰机、透明制冰机、流体制冰机，广泛用于食品的加工及储藏、化工、生物制药、电子、船舶、制冰、石化等领域。公司产品不仅遍布全中国，同时还远销到美国、日本以及东南亚等多个国家，先后为1000多家大型企业、高校实验室提供产品和服务。

公司致力于制冷行业多年，坚持以“技术开拓市场，品质树立形象”为企业发展理念，不断学习尖端的制冷技术，同时结合实际应用经验，从产品的性能、能效、操控等多方面改进产品的质量，产品获得了CE、ISO9001质量管理体系认证，并得到了用户的高度评价。

博朗将会不遗余力地投身于制冷行业，为人类的美好生活环境，提供更加环保、安全、节能、优质的产品。

Established in 2012, Nantong BOLANG Refrigeration Equipment Co., Ltd. is a comprehensive company integrating design, research and development, production, sales and service, specializing in the production of ICE machines, freezing and cold storage. BOLANG is a comprehensive company with design, R&D, production, sales and service, specializing in the production of freezing and refrigeration equipments, food quick-freezing processing equipments and heat recovery equipments, chemical chiller units, exhaust gas recovery equipments, as well as one-stop cold chain logistics solutions.

BOLANG's main business: block ice machine, tube ice machine, cube ice machine, flake ice machine, transparent ice machine, fluid ice machine, widely used in food processing and storage, chemical industry, biopharmaceuticals, electronics, ships, ice making, petrochemicals and other fields, Ship, ice making, petrochemical and other fields. Our products are not only distributed throughout China, but also exported to the United States, Japan and Southeast Asia and other countries, has provided products and services for more than 1,000 large-scale enterprises, We have provided products and services for more than 1000 large-scale enterprises, laboratories of colleges and universities.

The company is committed to the refrigeration industry for many years, adhere to the "technology to develop the market, quality to establish the image" as the concept of enterprise development, and constantly learn the cutting-edge refrigeration technology, combined with the actual application experience, from the product We constantly learn the cutting-edge refrigeration technology and combine it with the practical application experience to improve the quality of products in terms of performance, energy efficiency, control, etc. Our products have been certified by CE、ISO9001 quality management system and have been highly evaluated by the users. The products have obtained ISO9001 quality management system certification and have been highly evaluated by users.

BOLANG will spare no effort to devote itself to the refrigeration industry and provide more environmentally friendly, safe, energy-saving and high-quality products for the better living environment of human beings.



COURSE

历程篇

发展历程



2008年3月

In 2008, Nantong Guangzhengtong Cooling and Heating Equipment Co., Ltd. was established, the main business is the installation of refrigeration equipment, and then the business was expanded to the production of equipment, namely Bolang.

2012年

Established Braun factory, passed ISO9001 quality management system certification

2009年-2011年

Main business: (Shanghai Maritime University) Ship Refrigeration Teaching Laboratory, (Shanghai Zhangjiang Pharmaceutical Valley) Biological specimen laboratory; electronic constant temperature and humidity carroom; pharmaceutical cold storage; industrialized mushroom raising temperature-variable storageroom; seafood, meat quick-frozen and storage warehouse; waterfruits and vegetables; brine ice-making equipment and Engineering; industrial plant refrigeration engineering

2013年

Launched the double-machine mating unit. Mainly used in freezers and freezers.

2014-2017年

The product coverage is getting wider and wider, including scroll units, piston units, screw compression condensing units, low and medium-sized condensing units, piston units, screw compression condensing units, low and medium temperature screw chiller units, full-liquid-carrier chiller unit, single-unit bipolar units, cascade units, etc., and has been awarded the honorary title of "The best chiller in the world" by Germany BITZER, America Carrier, Italy Fuji BITZER (Germany), CARRIER (USA), FUJI (Italy), HANZHONG (Taiwan), etc.

2018年

Acquisition of the National Industrial Products Production License

2019年

National High-tech Enterprise

2019年-2023年

Domestic sales and service outlets cover more than 80% of the country's provinces and municipalities, and set up three offices (South, Southwest and Northwest China). South, Southwest, Northwest), international trade has involved in East South Asia, Japan, Russia and other regions.

2023年

Self-built national refrigeration laboratory, design and R & D team has refrigeration masters, doctors The production scale is expanding, and the product line product line continues to extend to the application

APTITUDE CHAPTER

资质篇

资质证书



块冰机
Block Ice Machine

管冰机
Ice Tube Machine

方冰机
Ice Cube Machine

片冰机
Flake Ice Machine

透明制冰机
Clear Ice Machine

流态冰机
Fluid Ice Machine

目录CONTENTS

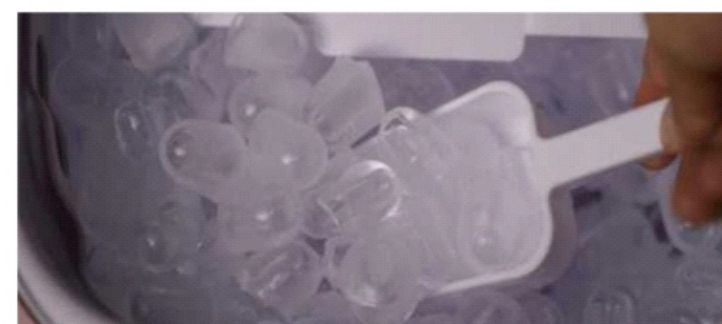
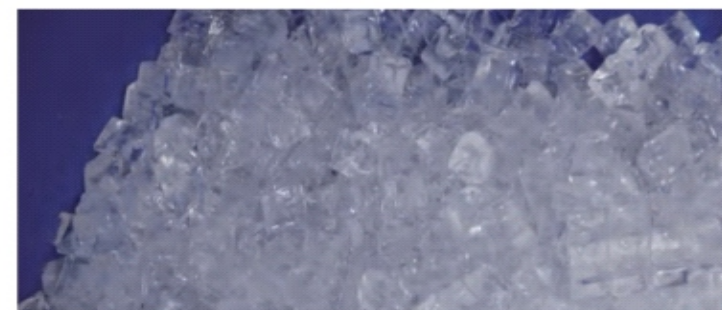

块冰机

Block Ice Machine



Product Introduction

Direct cooling ice block machine: a new type of ice maker, which evaporates a refrigerant inside the evaporator and directly cools water through the evaporator for ice production. The main components include the refrigeration system, lifting device, and control system.

The evaporator is made of aluminum flat plate, with the refrigerant circulating inside the aluminum plate, and the outside directly exchanging heat with water for ice-making.

Product Advantage

1. Compact structure, small equipment volume and small footprint.
2. Small heat transfer temperature difference, more energy-efficient in the same ice-making cycle.
3. Simple operation and maintenance of production and equipment, which saves time.
4. No pollution to the environment and ice, and can make edible ice.

产品介绍

直冷式冰块机：一种新型制冰机、在蒸发器内蒸发制冷剂，并通过蒸发器直接冷却水，从而制冰。主要部件包括制冷系统、提升装置。蒸发器由铝制平板制成，制冷剂在铝板内循环，外部直接与水换热制冰。

产品优势

1. 结构紧凑，设备体积小，占地面积小。
2. 传热温差小，在同一制冰周期内更节能。
3. 生产和设备操作维护简单，节省时间。
4. 对环境和冰无污染，可制作食用冰。

用途

APPLICATION

冷藏食品
Chilled food

混合饮料
Mixed drinks

土木工程
Civil engineering

冷冻饮料
Frozen beverages

日常消耗
Daily consumption

化学工艺
Chemical processes

蔬菜保鲜
Vegetable preservation

以及其他需要冰的供应
And other places that require ice supply



布局示意图

LAYOUT DIAGRAM

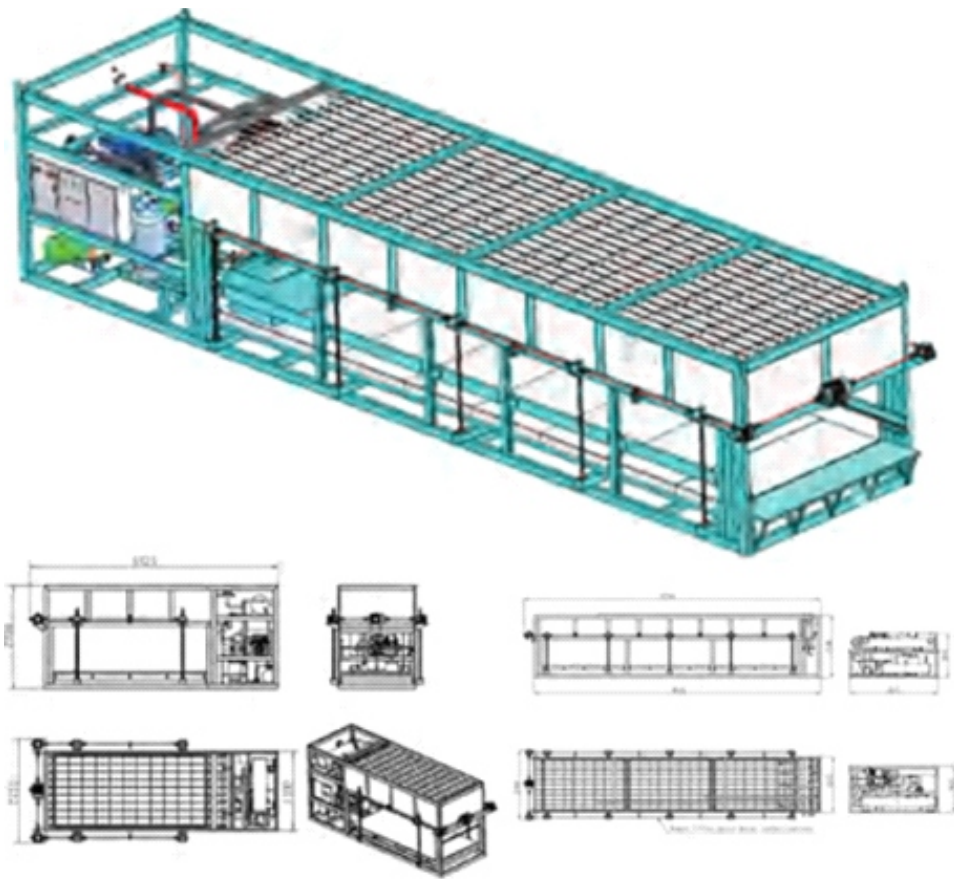

冰砖耗电量低，不易融化，便于远距离储存。贮存。块冰机受到各大冰品销售厂、冷鲜配送、远洋捕捞等行业的青睐。广泛应用于水产品加工、屠宰加工、蔬菜配送保鲜、超市保鲜等行业。与传统的盐池制冰块冰机相比，直冷式块冰机具有自动操作、方便、卫生、使用寿命长、耐腐蚀等明显优势，成为世界发展的新趋势。

Because of its low power consumption, ice bricks are not easy to melt, and convenient for long-distance storage. Block ice machines are favored by major ice sales factories, cold fresh distribution, ocean fishing and other industries.It is widely used in aquatic product processing, slaughter processing, vegetable distribution and preservation, supermarket freshness, aquatic product market preservation, marine fishery etc. Compared with the traditional salt pool ice making block ice machine, the obvious advantages of the direct cooling block ice machine, such as automatic operation, convenience, sanitation, long service life, and resistance to corrosion, make it a new trend in the world.

直接冷却与盐水冷却

DIRECT COOLING VS SALT WATER

我们还提供集装箱式直接冷却块冰机和盐冰块冰机。
We also provide containerized direct cooling block ice machines and brine block ice machines.

制冰效率 Ice making efficiency	传统的盐水冰砖机 Traditional brine ice block machine	博朗直冷冰块机 BOLANG direct cooling ice block machine	说明 Description
制冰效率 Ice making efficiency	盐水被用作制冷剂进行 2 次热交换 制冰周期长 Salt water is used as the refrigerant for 2 heat exchanges Long ice making cycle	需要加水，抬起融化的冰、效率低 Need to add water, lift melt ice, pourioe low efficiency	首选直接冷却 Preferred direct cooling
出冰效率 Ice output efficiency	需要加水、升降、融冰、倒冰 效率低 Need to add water, lift, melt ice, pour ice low efficiency	热氟被高效脱水,脱水后的氟直接落在输送装置,整个过程几乎完全自动化。 Hot fluorineis efficienlty dehydrated. After dehydration,it directly fallson the conveying device with high effidenty.The whole proces is almost fully automated	首选直接冷却 Preferred direct cooling
节能效果 Energy saving effect	需要进行 2 次热交换，制冰 制冰能耗标准 80~110kw.h/ton Need to carry out 2 heat exchanges, ice making energy consumption standard value 80~110kw.h/ton	热交换速度快制冰能耗指标为 70~75kw.h/吨。节能近 20 % The heat exchange speed is fast; the index value of ice making energy consumption is 70~75kw.h/ton.Nearly 20% energy saving	首选直接冷却 Preferred direct cooling
卫生 Hygiene	冰块很容易受到盐水和防腐剂 Block ice is easily contaminated by salt water and preservatives	冰块不会受到污染、可食用 Ice cubes will not be contaminated, dean and edible	首选直接冷却 Preferred direct cooling
设计寿命 Design life	设计寿命不超过 20 年、冰桶容易腐蚀，需要经常维修。 The design life is not more than 20 years, the ice bucket is easy to corrode,Need to be repaired frequently	设计寿命为 30 年 Design life is 30 years	首选直接冷却 Preferred direct cooling
运 输 Transport	附件多，运输和安装不便施工周期长、易受场地影响 Many accessories,inconvenient transportation and installation, long construction period, Easily affected by the venue	占地面积小，可与水电一起大规模使用，可用水和电做成一个容器 Occupying a small area,large-scale can be used with water and electricity Made Into a container	首选直接冷却 Preferred direct cooling
投资成本 Investment cost	制冷系统简单且系统成本低 The refrigeration system is simple and the system cost is low	制冷系统更复杂,系统成本高 The refrigeration system is more complicated and the cost of the system is high	首选直接冷却 Preferred direct cooling
运行成本 Operating cost	面积大、易损件多、维护成本高 Large area, many wearing parts, high maintenance cost	地板面积仅为盐水型的 55%左右,而且零部件很少,维护成本低。 The floor area is only about 55% of the salt water type and there are few weaning parts.Low maintenance cost	首选直接冷却 Preferred direct cooling
冰模规格 Ice mold specifications	冰模的尺寸可根据客户要求定制根据客户要求 The size of the ice mold can be customized according to customer requirements	根据最佳尺寸设计、固定尺寸 Designed according to the optimal size, fixed size	首选直接冷却 Preferred direct cooling

注：经综合比较，直冷式块冰机比盐冰块冰机性价比更高，首选直冷式块冰机。
Note: After a comprehensive comparison, the direct cooling ice brick machine is more cost-effective than the salt water ice brick machine, and the direct cooling ice brick machine is preferred.

块冰机

Block Ice Machine



BL-k10/1 吨/天 风冷块冰机/人工式
BL-k30/3 吨/天 风冷块冰机/人工式
BL-k10/1 ton per day Block Ice Machine/Air-cooling
BL-k30T/3 tons per day Block Ice Machine/Air-cooling

BL-K50/5 吨/天 块冰机/水冷
BL-K80/8 吨/天 块冰机/水冷
BL-K50/5 tons per day Block Ice Machine/Water cooling
BL-K80/8 tons per day Block Ice Machine/Water cooling



BL-K100/10 吨/天 块冰机/水冷
BL-K150/15 吨/天 块冰机/水冷
BL-K200/20吨/天 块冰机/水冷
BL-K300/30吨/天 块冰机/水冷
BL-K100/10 tons per day Block Ice Machine/Water cooling
BL-K150/15 tons per day Block Ice Machine/Water cooling
BL-K200/20 tons per day Block Ice Machine/Water cooling
BL-K300/30 tons per day Block Ice Machine/Water cooling

参数

Parameters

*1t.3t,5t,8t,10t,15t,20t,30t/24hrs

型号 Model	BLG-K10	BLG-K30	BLG-K50	BLG-K80	BLG-K100	BLG-K150	BLG-K200	BLG-K300
每日产出 Daily output	1t/24hrs	3t/24hrs	5t/24hrs	8t/24hrs	10t/24hrs	15t/24hrs	20t/24hrs	30t/24hrs
冷却能力 Cooling capacity	9.5kw	25kw	44kw	81kw	95kw	150kw	180kw	295kw
总功率 Total power	5kw	12kw	20kw	36kw	45kw	68kw	83kw	123kw
冰 重 Ice weight	25kg	25kg	25kg	25kg	25kg	50kg	50kg	50kg
冰模 Nubeer of ice molds	20pcs	65pcs	99pcs	160pcs	204pcs	165pcs	204pcs	308pcs
冻结时间 Freezing time	8h	8h	8h	8h	8h	9h	9h	9h
冷却方法 cooling method	风冷 Air-cooling	风冷 Air-cooling	水冷 Water cooling	水冷 Water cooling	水冷 Water cooling	水冷 Water cooling	水冷 Water cooling	水冷 Water cooling
水的供应压力 Water supply pressure	0.1Mp-0.5Mp	0.1Mp-0.5Mp	0.1Mp-0.5Mp	0.1Mp-0.5Mp	0.1Mp-0.5Mp	0.1Mp-0.5Mp	0.1Mp-0.5Mp	0.1Mp-0.5Mp
单位面积 Unit size	3300x1480x2000 (mm)	4700x2100x2000 (mm)	5500x2100x2000 (mm)	7500x2540x2350 (mm)	7900x28000x2450 (mm)	8800x31000x2600 (mm)	10500x31000x2700 (mm)	13200x35000x2700 (mm)

- *环境温度0°C-45°C, 水温≤30°C
- *蒸发温度:-15°C, 冷凝温度:40°C
- *电源:3P/380V/50HZ、3P/220V/60HZ、3P/380V/60HZ、3P/460V/60HZ可选
- *制冷剂:R22、R404A、R507A
- *冰块重量:5KG-100KG
- * Ambient temperature 0°C-45°C, water temperature: ≤30°C
- * Evaporating temperature: -15°C, Condensing temperature: 40°C
- * Power supply: 3P/380V/50HZ, 3P/220V/60HZ, 3P/380V/60HZ, 3P/460V/60HZ optional
- * Refrigerant: R22, R404A, R507A
- * Ice weight: 5KG-100KG

管冰机

Ice Tube Machine

产品介绍

大型管式制冰机采用模块化设计并分为三个部分:蒸发器、制冷机组与冷却塔,采用分体式设计。蒸发器采用立式壳管式装置,配有不锈钢换热管穿过上下管板,和水箱一起贯穿。管式制冰机的高度蒸发器相对较高。在运输过程中,蒸发器可垂直放置和安装现场,满足集装箱运输要求。

Product Introduction

The large tube ice machine adopts a modular design and is divided into three parts:evaporator,refrigeration unit and cooling tower,using a split-type design. The evaporator adopts a vertical shell and tube device, with stainless steel heat exchange tubes passing through the upper and lower tube sheets,and a water tank at the top and bottom.The height of the tube ice machine evaporator is relatively high.During transportation,the evaporator can be laid down and installed vertically on site,meeting the requirements of container transportation.



机组配置

压缩机、冷凝器、储液罐、油分离器、气体分离器和电气控制分离器、气体分离器和电气控制箱。

Refrigeration Unit Includes

compressors,condensers,liquid storage tanks,oil separators,gas separators,and electrical control boxes.



正常运行
冷冻饮料
混合酒类
冰镇食品
蔬菜保鲜
化学工艺
建筑工艺

Normal operation
Frozen beverages
Blended liquor
Iced food
Vegetable preservation
Chemical process
Construction process

布局示意图

Layout Diagram

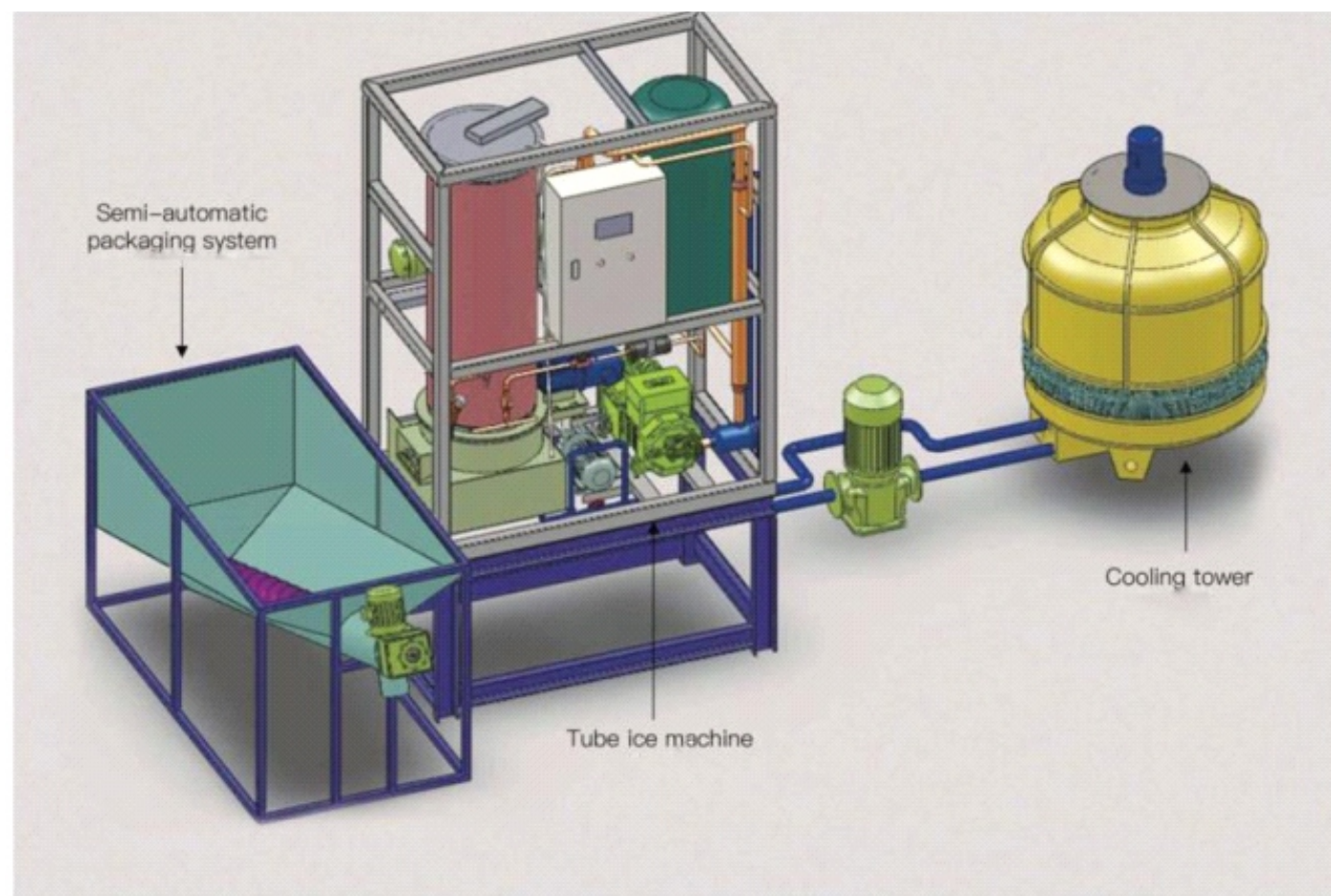

大型管式制冰机采用模块化设计,分为蒸发器、制冷机组和冷却塔三部分,并采用分体式设计。

The large tube ice machine adopts a modular design, which is divided into three parts: evaporator, refrigeration unit, and cooling tower, and adopts a split design.

配件介绍

Accessories Introduction



压缩机

管式制冰机采用名牌压缩机,效率高、消耗低、噪音小、使用寿命长。

C*O*M*P*R*E*S*S*O*R
Tube Ice Machine adopts famous brand, bitzer compressor, high efficiency, low consumption, low noise and long service life.



触摸屏

操作简单:控制箱采用 PLC 微电脑程序控制,自动制冰、自动落冰、自动出冰。自动制冰、自动落冰、自动出冰;故障智能显示。

T*O*U*C*H*S*C*R*E*N
Simple operation: the control box adopts PLC microcomputer program control; automatic ice making, ice falling and ice out; fault intelligent display.



蒸发器

蒸发器材料为不锈钢SUS304、铝合金板。博朗拥有先进的工艺技术和科学的蒸发器设计,使蒸发器无任何占地空间。使其达到HACCP、FDA等国际标准。

E*V*A*P*O*R*A*T*O*R
Stainless steel SUS304, aluminum alloy plate as the material for the evaporator. BOLANG has advanced technology skill and scientific design for the evaporator to achieve no any dead space for the cleaning. Making it reach to international standard such as HACCP, FDA qualification.



出冰口

当冰块从管道中落下时,会被旋转的切冰机切割成所需的大小。切割成所需的大小。

I*C*E*O*U*T*L*E*T
As the ice falls from the tubes it is cut by the rotating ice cutter to a desired size.

管冰机

Ice Tube Machine

*中小型管式制冰机：日产量从1吨到8吨不等。冷却方式：水冷或风冷，可定制。
*Small and medium tube ice machine:daily capacity from 1ton to 8tons.Cooling way:water cooling or air cooling,can be customized

* BL-G10/1 吨/天管式制冰机/风冷
*BL-G10/1 ton per day Tube Ice Machine/Air cooling



* BL-G30/3 吨/天管式制冰机/水冷
* BL-G30/3tons per day Tube Ice Machine/Water cooling



* BL-G50/5 吨/天管式制冰机/风冷
* BL-G50/5tons per day Tube Ice Machine/Air cooling



技术参数

Parameters

型 号 Model		BLG-G10	BLG-G20	BLG-G30	BLG-G50	BLG-G80
容量(吨/24 小时) Capacity(Tons/24hours)		1	2	3	5	8
制冷剂 Refrigerant		R22/R404A/R507				
压缩机品牌 Compressor Brand		Bitzer/Refcomp				
冷却方式 Cooling Way		Water/Air Cooling				
压缩机功率 Compressor Power(HP)		4	9	14(12)	28	44(34)
切冰机电机 Ice Cutter Motor(KW)		0.37	0.37	0.55	0.75	1.1
循环水泵功率(千瓦) Power of Circulating Water Pump(KW)		0.37	0.37	0.55	0.75	1.1
水冷泵功率(千瓦) Power of Water Cooling Pump(KW)		0.75	1.1	1.5	2.2	2.2
冷却塔电机(千瓦) Cooling Tower Motor(KW)		0.18	0.37	0.55	0.75	1.5
制冰机尺寸 Ice Machine Size	L(mm)	1520/1600	1550/1650	1680/1700	1790	2200
	W(mm)	1000/1350	910/1090	950/1400	1080	1900
	H(mm)	2020/2010	2010/2300	2200/2430	2270	2550

电源:380V/50Hz/3P 415V/50Hz/3P 220V/60Hz/3P 380V/60Hz/3P 440V/60Hz/3P 220V/50Hz/1P;
标准条件:进水温度:21℃,环境温度:25℃,冷凝温度:40℃;以上数据以最终设计为准,恕不另行通知。
◆ Power supply:380V/50Hz/3P 415V/50Hz/3P 220V/60Hz/3P 380V/60Hz/3P 440V/60Hz/3P 220V/50Hz/1P;Standard conditions:water input temperature:21℃,ambient temperature:25℃,condensing temperature:40℃; The above data is subjected to the final design without notice.

方冰机

Ice Cube Machine

产品优势

Product Advantages

智能控制

Intelligent Control

PLC 控制，一键式操作，自动供水自动调节环境温度；自动调节冰块厚度。

PLC control,one-key operation,automatic water supplying,ice making and ice falling.Automatic adjustment for ambient temperature;automatic adjustment for ice thickness.

优质冰块

Superior ice

冰块晶莹、坚硬、规则、棱角分明，外观优雅、储存时间长，干净卫生。完全符合国家食用冰卫生标准、有多种规格可供选择。

The ice is crystal,hard,regular,angular, elegant appearance,long storage time, clean.Fully comply with the national edible ice health standards,various specifications available.

卫生设施

Sanitation

机身由 SUS304 不锈钢制成；特殊水槽设计，自动清洗；纯净、卫生、安全。符合 QS 检验标准。

The machine body is made of stainless steel SUS304; special water sink design,automatic cleaning; pure,sanitary,safe and meet QS inspection standard.



高产冰量

High Ice Capacity

单机额定制冰能力为 1-20 吨/天，当环境温度 $\leq 20^{\circ}\text{C}$ 时，最大制冰能力可达 130%。当夏季环境温度较高时，工业制冰机的制冰能力可达到 90-95%，而商用风冷式制冰机的制冰能力在 1 吨以下时，只能达到 60-70%。

The nominal ice capacity of one machine is 1-20 tons per day.When the ambient temperature is $\leq 20^{\circ}\text{C}$,the maximum ice capacity can reach 130%.When the ambient temperature is high in summer,the industrial ice machine can reach 90-95% capacity while for commercial air-cooled type ice maker.Less than 1 ton capacity,it can only reach 60-70%.

低耗电量

Low Power Consumption

当环境温度 $\leq 23^{\circ}\text{C}$ 时，1 吨冰的耗电量为 70-85 千瓦时、商用立方体制冰机每吨冰的耗电量为 130-160 千瓦时。吨冰的耗电量为 130-160 千瓦时。

When the ambient temperature is $\leq 23^{\circ}\text{C}$,it takes 70-85 KWH for 1 ton of ice.When the ambient temperature is high in summer, the power consumption will be 85-90 KWH for 1 ton of ice.For commercial type cube ice maker,it will consume 130-160 KWH per ton of ice.

应用

Application

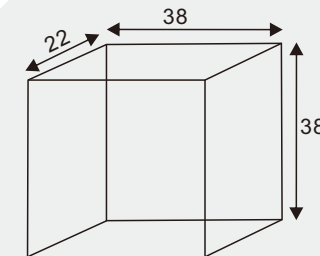
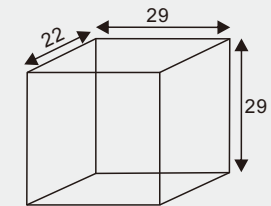
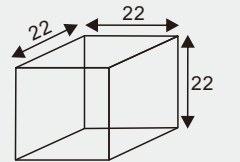
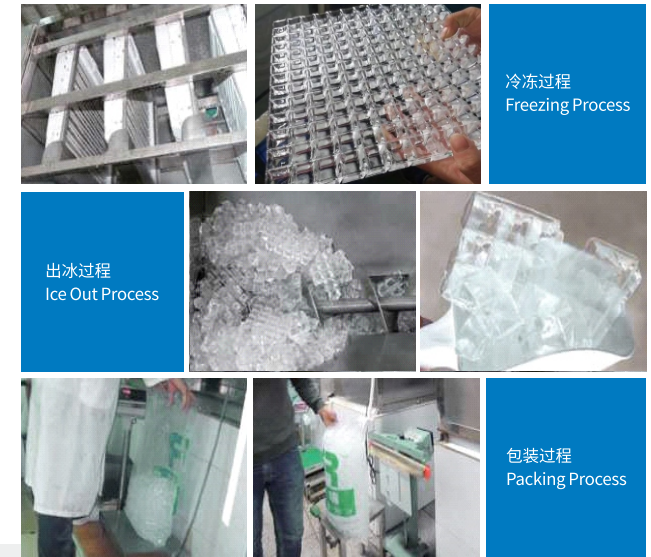

三种冰块尺寸，供不同国家和地区的客户选择。
供不同国家和地区的客户选择。
Three kinds of ice size which is optional for different customers in different countries and regions.

Size:
22*22*22mm
29*29*22mm
38*38*22mm

布局示意图

Layout Diagram

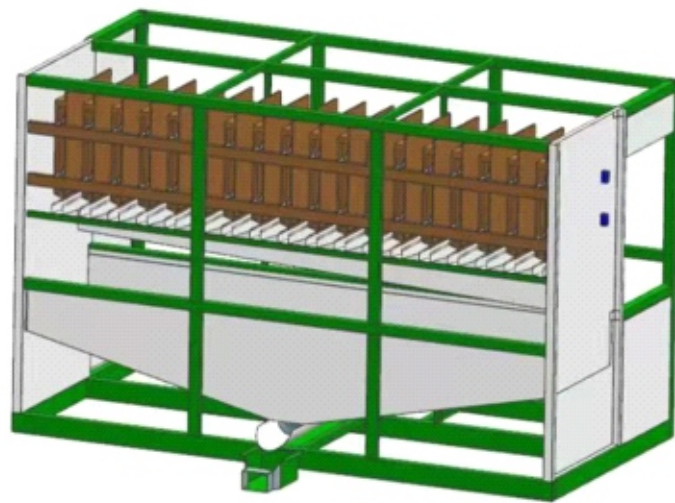

Length: 2960mm
Width: 1460mm
Height: 1860mm

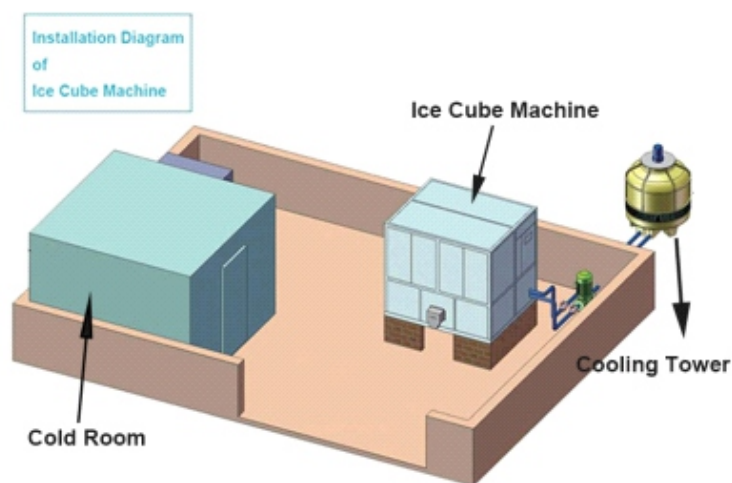

制冷效果极佳, 制冰速度快且节能。

Excellent cooling effect, fast ice making and energy saving.

BL 系列方冰机采用水冷系统。冷却塔安装在室外, 通过水泵为机器制冷。

BL series ice cube machine adopts water cooling system. The cooling tower will be installed outdoors and provide cooling for the machine via water pump.

配件介绍

Accessories Introduction



压缩机

BOLANG Ice Cube Machine (博朗方冰机) 采用名牌、比泽尔压缩机, 效率高、消耗低、噪音小、使用寿命长。

C*O*M*P*R*E*S*S*O*R
BOLANG Ice Cube Machine adopts famous brand, bitzer compressor, high efficiency, low consumption, low noise and long service life.



触摸屏

操作简单: 控制箱采用 PLC 微电脑程序控制; 自动制冰、落冰、出冰; 故障智能显示。

T*O*U*C*H*S*C*R*E*N
Simple operation: the control box adopts PLC microcomputer program control; automatic ice making, ice falling and ice out; fault intelligent display.

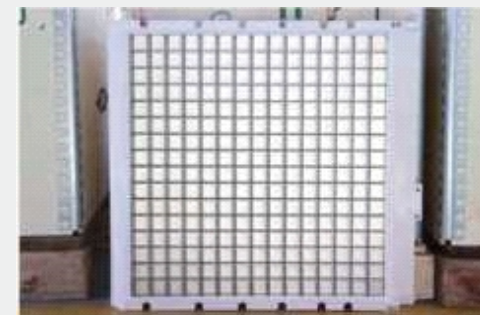

蒸发器

240/380 格栅由纯镀镍铜制成, 坚固、防腐蚀、卫生、制冰速度快、使用寿命长。

E*V*A*P*O*R*A*T*O*R(Ice Maker Grids)
240/380 grids made of pure nickel plated copper, firm, anti-corrosion, sanitary, fast ice making, and longer service life.



出冰口

采用 SUS304 不锈钢, 脚踏开关, 自动出冰, 操作简单。

I*C*E O*U*T*L*E*T
It adopts stainless steel SUS304, and used with pedal switch, automatic ice out and simple operation.

方冰机

Ice Cube Machine

*中小型冰块机:日产量从 1 吨到 5 吨不等, 主要通过水冷, 可定制。
*Small and medium ice cube machine:daily capacity from 1ton to 5tons,mainly for water cooling,can be customized.



* BL-F1000/1 吨/天 方冰机/风冷
* BL-F1000/1 ton per day Ice Cube Machine/Air cooling



* BL-F3000/3 吨/天 方冰机/水冷
* BL-F3000/3tons per day Ice Cube Machine/Water cooling



* BL-F5000/5 吨/天 方冰机/水冷
* BL-F5000/5tons per day Ice Cube Machine/Water cooling

中小型冰块机参数

Small and Medium Ice Cube Macihne Parameters

型 号 Model		BLG-F1000	BLG-F2000	BLG-F3000	BLG-F4000	BLG-F5000
容量 (吨/24 小时) Capacity(Tons/24hours)		1	2	3	4	5
制冷剂 Refrigerant		R22/R404A/R507				
压缩机品牌 Compressor Brand		Bitzer/Refcomp				
冷却方式 Cooling Way		Water/Air Cooling				
压缩机功率 Compressor Power(HP)		4	9	14(12)	23	28
切冰机电机 Ice Cutter Motor(KW)		0.75	0.75	1.1	1.1	1.1
循环水泵功率 (千瓦) Power of Circulating Water Pump(KW)		0.25	0.37	0.55	0.75	0.75
水冷泵功率 (千瓦) Power of Water Cooling Pump(KW)		0.75	1.1	1.5	2.2	2.2
冷却塔电机 (千瓦) Cooling Tower Motor(KW)		0.18	0.37	0.55	0.75	0.75
制冰机尺寸 Ice Machine Size	L(mm)	1700/1800	1730/2150	2100/3158	2620	3110
	W(mm)	1230/1650	1520/1640	1940/1950	1940	1940
	H(mm)	1970/1750	2030/2030	2050/2030	2040	2040

电源:380V/50Hz/3P 415V/50Hz/3P 220V/60Hz/3P 380V/60Hz/3P 440V/60Hz/3P 220V/50Hz/1P; 标准条件:进水温度:21℃, 环境温度:25℃, 冷凝温度:40℃; 以上数据以最终设计为准, 恕不另行通知。

◆ Power supply:380V/50Hz/3P 415V/50Hz/3P 220V/60Hz/3P 380V/60Hz/3P 440V/60Hz/3P 220V/50Hz/1P; Standard conditions:water input temperature:21℃,ambient temperature:25℃,condensing temperature:40℃; The above data is subjected to the final design without notice.

片冰机

Flake Ice Machine

产品特点

Product Features

- 制冷机组采用 Bitzer、Refcomp、GEA 和 Hanbell 等世界知名品牌压缩机，制冰速度快。
- 扁平形状的冰干燥而光滑。在冷藏和包装过程中，它能保护食物不受损害。大面积的扁平冰的可确保与冷藏物品充分接触，迅速降低其温度。
- 融化的水还能湿润冷藏物品的表面，减少水分流失。
- 微电脑智能控制采用一键式自动操作模式。屏幕上会显示缺水、反转、冰满、高低压等警告信息，有效防止异常操作，降低机器损坏率。
- 蒸发器采用固定不动的立式设计，是一种内部刮冰方式。
- 蒸发器静止不动，切冰刀片旋转并刮除其内壁上的冰块。这种设计减少了磨损，并保持较高的密封性能，有效防止制冷剂泄漏。它采用优质 304 不锈钢材料和全自动焊接技术，提高了强度和精度。
- 滚动式螺旋冰刀具有低阻力、低磨损、无噪音的特点，并能产生均匀的冰。
- The refrigeration unit uses world-renowned brand compressors such as Bitzer, Refcomp, GEA, and Hanbell , which enables fast ice-making speed.
 - The flat-shaped ice is dry and smooth. During the cold storage and packaging process, it protects the food from damage. The large surface area of the flat-shaped ice ensures sufficient contact with the refrigerated items, quickly lowering their temperature. The melted water can also moisten the surface of the refrigerated items, reducing water loss.
 - Microcomputer intelligent control adopts a one-key automatic operation mode.It displays warning information such as water shortage, reversal,ice full,high and low pressure on the screen, effectively preventing abnormal operation and reducing machine damage rate.
 - The evaporator adopts a fixed stationary vertical design, which is an internal scrape ice-making method.
 - The evaporator remains stationary, and the ice-cutting blade rotates and scrapes the ice on its inner wall. This design reduces wear and tear and maintains high sealing performance, effectively preventing refrigerant leakage. It adopts high-quality 304 stainless steel material and fully automatic welding technology to improve its strength and accuracy.
 - The rolling spiral ice cutting blade has low resistance, low wear, no noise , and produces uniform ice.



应用

Application



小型商用片冰机主要用于超市/酒店/海鲜保鲜/蔬菜市场/小型水产品/肉类加工。

日产量:0.2 吨 (200 千克) ~ 2 吨, 通常带有储冰装置。

Small commercial flake ice machine is mainly used for supermarket /hotel/seafood preservation/vegetable market/small aquatic products/meat processing.

Daily capacity:0.2tons (200kg) ~ 2tons,usually with ice storage.

大型超市
肉类加工
水产食品加工
禽类屠宰
染料化学工业
远洋渔业
混凝土建筑工程
实验室
Large supermarket
Meat processing
Aquatic food processing
Fowl slaughtering
Dye chemical industry
Ocean-going fishing
Concrete construction project
Laboratories



安装示意图

Installation Diagram

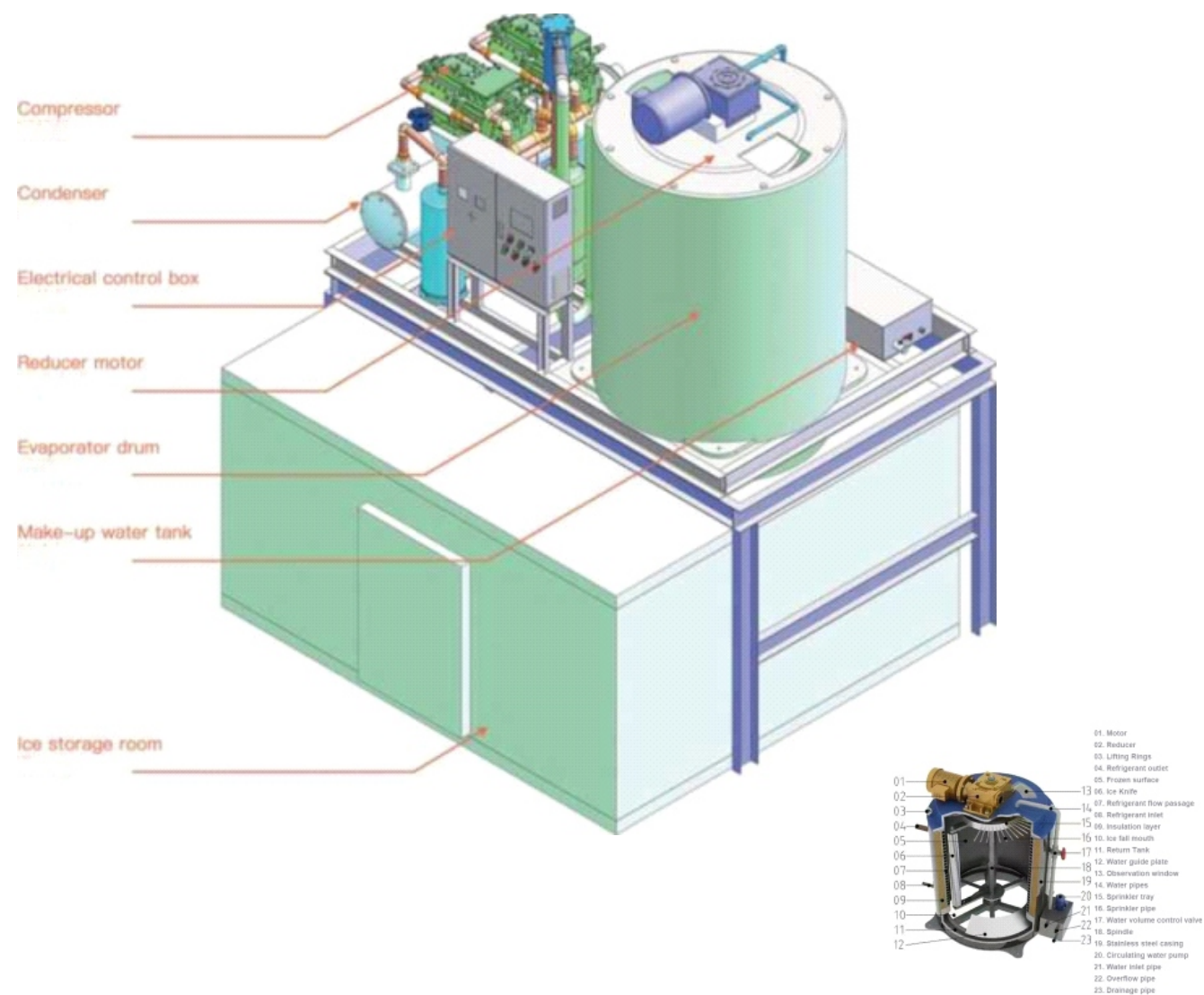

片冰机系统的安装结构布局:主要包括片冰机、储冰室、冷却塔和支撑架。

Installation structure layout of flake ice machine system:it mainly includes flake ice machine,ice storage room,cooling tower and supporting frame.We design It according to your site and provide you with the best proposal.

配件介绍

Accessories Introduction



压缩机

1、比泽尔
2、莱富康
3、汉钟
4、艾默生

Compressor

1、Bitzer
2、Refcomp
3、Hanbell
4、Emerson



一次性形成的刀片
One-time-forming blade



智能触摸屏
Intelligent touch screen



补水箱
Make-up water tank

片冰机
Flake Ice Machine



* BL-P02/200 公斤/天 片冰机/风冷
* BL-P02/200kg per day Flake Ice Machine/Air cooling



BL-P05/500 公斤/天 片冰机/风冷
BL-P05/500kg per day Flake Ice Machine/Air cooling

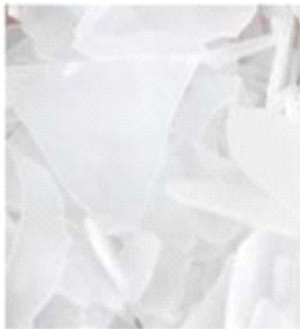

BL-P10/1 吨/天 片冰机/风冷
BL-P10/1ton per day Flake Ice Machine/Air cooling



BL-P20/2 吨/天 片冰机/风冷
BL-P20/2tons per day Flake Ice Machine/Air cooling



参数
Parameters

型号 Model	BLG-P02	BLG-P05	BLG-P10	BLG-P20
容量(吨/24小时) Capacity(Tons/24hours)	0.2	0.5	1	2
制冷剂 Refrigerant	R22/R404A/R507			
压缩机品牌 Compressor Brand	KK	Danfoss	Danfoss	Bitzer/Refcomp
冷却方式 Cooling Way	Air Cooling			
压缩机功率 Compressor Power(HP)	2	3	5	9
切冰机电机 Ice Cutter Motor(KW)	0.2	0.2	0.2	0.37
循环水泵功率(千瓦) Power of Circulating Water Pump(KW)	0.09	0.09	0.14	0.14
冷却塔电机(千瓦) Cooling Fan Motor(KW)	0.19	0.38	0.38	0.38
制冰机尺寸 Ice Machine Size	L(mm)	880	1620	1660
	W(mm)	870	1160	1340
	H(mm)	790	930	1040

电源:380V/50Hz/3P 415V/50Hz/3P 220V/60Hz/3P 380V/60Hz/3P 440V/60Hz/3P 220-230V/50Hz/1P;标准条件:进水温度:21℃,环境温度:25℃,冷凝温度:40℃;以上数据以最终设计为准,恕不另行通知。

◆ Power supply:380V/50Hz/3P 415V/50Hz/3P 220V/60Hz/3P 380V/60Hz/3P 440V/60Hz/3P 220-230V/50Hz/1P; Standard conditions:water input temperature:21℃,ambient temperature:25℃,condensing temperature:40℃; The above data is subjected to the final design without notice

透明制冰机

Clear Ice Machine



产品特点

Product Features

我们根据客户的要求生产透明冰块，透明制冰机符合我们生产透明冰块的特殊要求。从制冰机中取出的冰没有气泡，像水晶一样透明，不易融化。冰体晶莹剔透，坚固不易损坏。各种制产品可用于食品、医药、实验室等领域。

We produce transparent ice cubes according to the requirements of our customers, and the transparent ice machine meets our special requirements for producing transparent ice. The ice taken out from the ice machine has no air bubbles, is as transparent as crystal, and is not easy to melt. The ice body is crystal clear, strong and not easy to be damaged. Various kinds of manufactured products can be used in food, medicine, laboratory and so on.

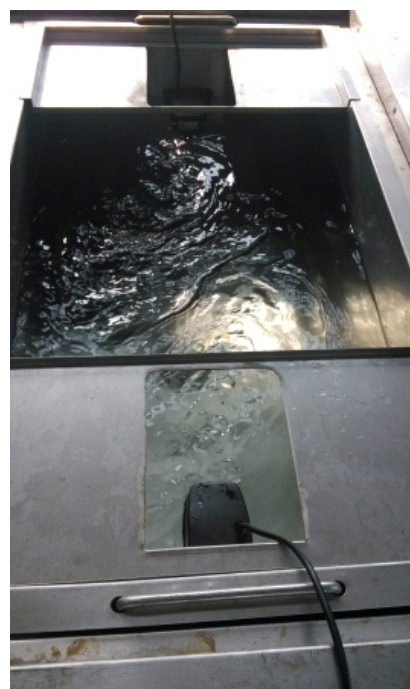

应用

Application



冷冻饮料
混合酒类
冰冻食品

蔬菜保鲜
化学工艺
建筑工艺

Frozen beverages
Blended liquor
Iced food

Vegetable preservation
Chemical process
Construction process

安装示意图
Installation Diagram

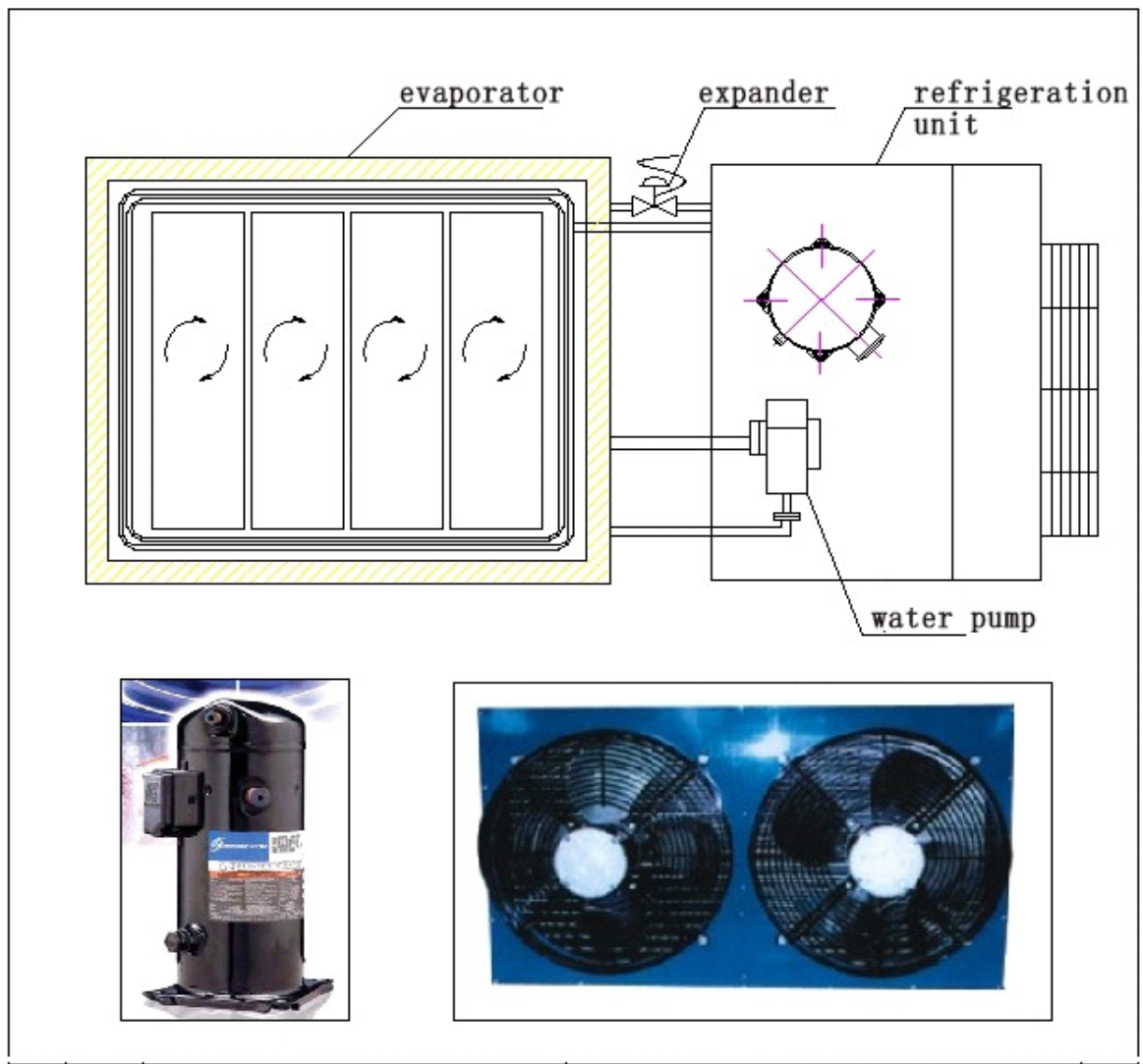

参数
Parameters

透明冰 - 制冰机 Transparent Ice - Ice Maker		
技术参数 Technical Parameter		
序号 Serial number	名称 Name	说明 Explain
1	制冰时间 Ice making time	72 hours
2	制冰量 Ice production	4 pieces/240KG
3	冰块尺寸和重量 Ice Block Size and Weight	60kg, 80*20*40cm
4	冰模 Ice mold	不锈钢Stainless steel
5	水箱 Water tank	不锈钢Stainless steel
6	压缩机组Compressor unit	2HP/Air-cooled
7	制冷剂 Refrigerant	R22
8	进水温度 Inlet water temperature	20-30
9	环境温度 Ambient temperature	35-40
10	数据Source	1.5KW/AC220W/50HZ

品牌:BOLANG 冷却方式:风冷; 电压:381V-1000V; 功率:5000W; 24小时制冰量: 1000 公斤
Brand: BOLANG; Cooling method: air cooling; Voltage: 381v-1000v; Power: 5000W; 24-hour ice production: 1000 kilograms

本机器应放置在周围通风良好、安全和清洁的地方。
This machine should be placed in a well ventilated, safe and clean area around it.

流态冰机

Fluid Ice Machine

产品特点

Product Features

流体制冰机是一种利用水和制冷剂混合形成流体冰悬浮液的特殊制冷设备，原理独特，应用广泛。

流体制冰机采用先进技术和创新设计，具有以下突出特点：

- ① 制造流体冰：流体制冰机通过向水中注入适量空气来制造小颗粒冰块。与传统冰块相比，流动冰的面积更大，冷却材料的速度更快。
- ② 快速冷却：由于流动冰表面积大，能更快地将热量传递给被冷却物体，使物品快速冷却，满足消费者的需求。
- ③ 保持食物的原汁原味：流冰由小颗粒冰块组成，与传统冰块相比，其溶解速度较慢。这意味着它不会过分冲淡冷却后的食物味道，能更好地冷冻和保存食物。

Fluid ice machine is a special type of refrigeration equipment that uses water and refrigerant to mix to form a fluid ice suspension, with unique principles and wide applications. The fluid ice machine adopts advanced technology and innovative design, with the following outstanding features:

- ① Manufacturing fluid ice: A fluid ice machine produces small granular ice cubes by injecting an appropriate amount of air into water. Compared to traditional ice cubes, flowing ice has a larger surface area and can cool the cooled material faster.
- ② Rapid cooling: Due to the large surface area of flowing ice, it can more quickly transfer heat to the cooled object, allowing the item to cool down quickly and meeting the needs of consumers.
- ③ Maintain the original taste of the item: Flowing ice is composed of small granular ice cubes, which have a slower dissolution rate compared to traditional ice cubes. This means that it does not excessively dilute the taste of the cooled material, and better freezes and preserves food.



应用

Application

增强视觉效果：流动冰具有独特的形状和外观，可为饮品增添视觉吸引力和艺术感。无论是在酒吧、咖啡店还是自助餐厅，流动冰块都能给顾客带来独特的视觉体验。

Enhance visual effects: Flowing ice has a unique shape and appearance, which can add visual appeal and artistic sense to the drink. Whether in bars, coffee shops, or self-service restaurants, flowing ice can bring customers a unique visual experience.



- | | |
|-----------------------|------|
| Bar | 酒吧 |
| Coffee shop | 咖啡厅 |
| Restaurant | 餐厅 |
| Fast food restaurants | 快餐店 |
| Hotels | 酒店 |
| Banquet Venue | 宴会场所 |
| Food display | 食品展示 |
| Food retail | 食品零售 |